

## Ecke 1

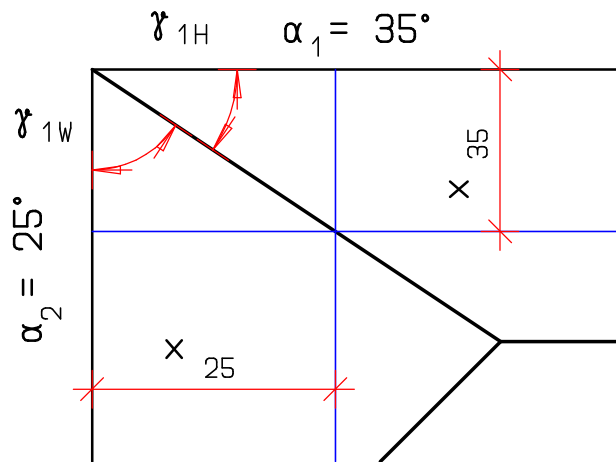

$$\gamma_{1H} = \tan^{-1} \frac{142,81}{214,45} = 33,662^\circ$$

$$\gamma_{1W} = \tan^{-1} \frac{214,45}{142,81} = 56,338^\circ$$

## Ecke 2 Die Gratgrundwinkel sind $45^\circ$

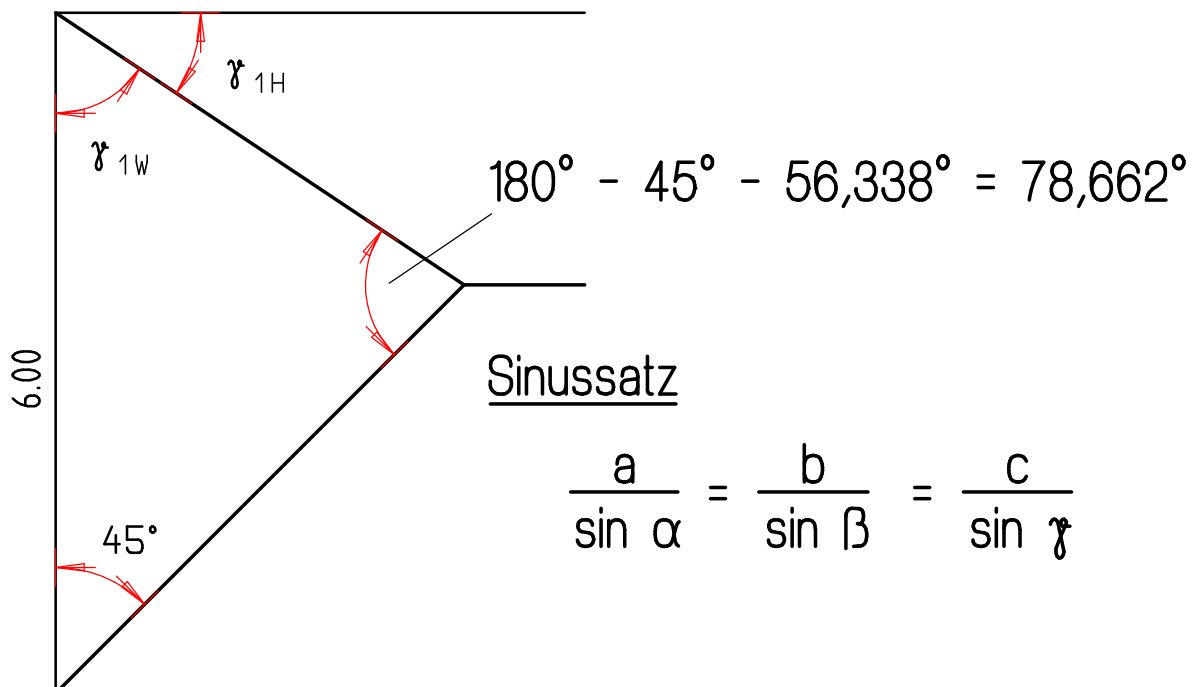

$$\frac{a}{\sin \alpha} = \frac{b}{\sin \beta} = \frac{c}{\sin \gamma}$$

$$a = \sin \alpha * \frac{c}{\sin \gamma} = \sin 56,338^\circ * \frac{600}{\sin 78,662^\circ} = 509,33$$

$$b = \sin \beta * \frac{c}{\sin \gamma} = \sin 45^\circ * \frac{600}{\sin 78,662^\circ} = 432,71$$