

Übungsbeispiele AM Kehlsparren

Lösungen

$$\begin{aligned}
 \boxed{1} \quad & h_{F,H} = 363,7\text{cm} \\
 & h_{F,A} = 272,8\text{cm} \\
 & \gamma_H = \gamma_A = 45^\circ \\
 & g_K = 594,0\text{cm} \\
 & \alpha_K = 24,665^\circ \\
 & l_K = 653,6\text{cm} \\
 & l_{SPf,K} = 132,3\text{cm}
 \end{aligned}$$

$$\begin{aligned}
 \boxed{2} \quad & \alpha_H = 27,751^\circ \\
 & h_{F,A} = 153,5\text{cm} \\
 & g_{K,H} = 291,8\text{cm} \\
 & \gamma_H = 37,52^\circ \\
 & \gamma_A = 52,48^\circ \\
 & g_K = 479,1\text{cm} \\
 & \alpha_K = 17,768^\circ \\
 & l_K = 503,1\text{cm} \\
 & l_{F,A} = 811,8\text{cm}
 \end{aligned}$$

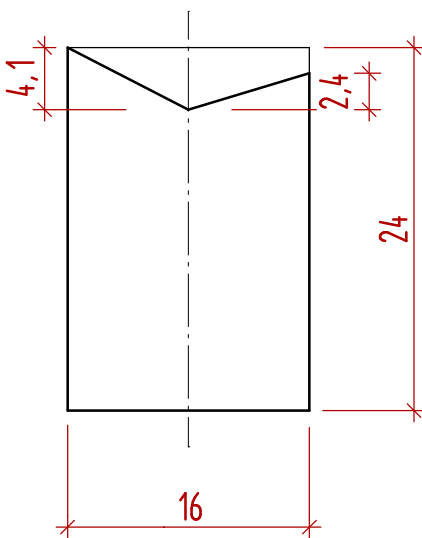

$$\begin{aligned}
 \boxed{3} \quad & h_{F,H} = 324,3\text{cm} \\
 & h_{F,A} = 224,3\text{cm} \\
 & g_{K,H} = 421,9\text{cm} \\
 & \gamma_H = 52,822^\circ \\
 & \gamma_A = 37,178^\circ \\
 & g_K = 529,5\text{cm} \\
 & \alpha_K = 22,960^\circ \\
 & l_K = 575,1\text{cm} \\
 & V_H = 6,07\text{cm} \\
 & ah_H = 2,4\text{cm} \\
 & V_A = 10,55\text{cm} \\
 & ah_A = 4,1\text{cm}
 \end{aligned}$$

$$\begin{aligned}
 \boxed{4} \quad & h_{F,A} = 196,7\text{cm} \\
 & g_{K,H} = 486,9\text{cm} \\
 & \gamma_H = 52,770^\circ \\
 & \gamma_A = 37,230^\circ \\
 & g_K = 611,6\text{cm} \\
 & \alpha_K = 17,833^\circ \\
 & l_K = 642,4\text{cm} \\
 & O_{VA} = 15,29\text{cm} \\
 & h_{Pf,A} = 176,7\text{cm} \\
 & h_{Pf,H} = 152,7\text{cm} \\
 & O_{VH} = 14,56\text{cm} \\
 & g_{Pf,H} = 413,9\text{cm} \\
 & \alpha_{Ab,A} = 92,60^\circ \\
 & \alpha_{Ab,K} = 69,71^\circ
 \end{aligned}$$